



CONSULTATION

ON THE PROPOSED DESIGN FOR WALLACE & GROMIT'S GRAND APPEAL'S NEW PATIENT HOTEL DEVELOPMENT ON LAND ADJACENT TO COTS FOR TOTS HOUSE BS2 8EJ

Consultation

The Grand Appeal, the Bristol Children's Hospital Charity, is working with Inspire Architects to design the new Patient Hotel proposal for patients and their families at Bristol Children's Hospital. This consultation seeks to inform the design prior to the submission of a planning application.

Why we are consulting

Designs showing how a new Patient Hotel development for patients and their families receiving treatment at The Bristol Royal Hospital for Children may look have been unveiled for public consultation and are now published in this document.

The designs are also available on our website at:

www.grandappeal.org.uk/latest-news/new-ground-breaking-facility-bristol-childrens-hospital

A paper copy of the proposals can be viewed at The Grand Appeal's HQ at 30-32 Upper Maudlin St, Bristol BS2 8DJ by appointment. Please email hello@grandappeal.org.uk or telephone 0117 927 3888 to arrange an appointment to visit.

The Grand Appeal and the design team would like to hear your views on the proposed design to help inform and shape the proposed development prior to submitting a planning application.

Timeframe

Consultation period
opens: 24th May 2024

Consultation period
closes: 7th June 2024

Feedback

There is a feedback form at the end of this document, together with details on how to feed back by other methods.

BACKGROUND

Wallace & Gromit's Grand Appeal (The Grand Appeal)

For nearly thirty years as the Bristol Children's Hospital Charity, The Grand Appeal has worked in partnership with the Bristol Children's Hospital and Bristol-based Aardman Animations to provide a multi-million pound portfolio of investment to support patients and their families at the hospital and the Neonatal Intensive Care Unit at St Michael's Hospital. Initially, The Grand Appeal raised £12 million pounds towards the construction of the new children's hospital on Upper Maudlin Street which opened in 2001, and since then continues to provide funding which enables the purchase of pioneering and life-saving equipment; clinical research into childhood illnesses and diseases; arts, music and play to provide therapy, distracting and a sense of normality for our young patients whilst in hospital as well as services, wellbeing support for staff and families and art enhancements throughout the hospital far beyond the constraints of NHS budgets.



In addition, we fund and operate 3 family accommodation houses - Cots for Tots House, Paul's House and Grand Appeal House - with 28 rooms, providing free accommodation to families who have babies and children cared for at Bristol Children's Hospital and the Neonatal Intensive Care Unit at St Michael's Hospital.



Bristol Royal Hospital for Children

Bristol Royal Hospital for Children is one of the world's leading children's hospitals and provides specialist treatment and lifesaving care to over 100,000 children from across the South West and South Wales each year. This huge region represents the largest geographical catchment area of any children's hospital in England. The Hospital is a centre of excellence in the UK for the treatment of a range of medical conditions including cancer, leukaemia, burns, neurosurgery, and epilepsy and has the only dedicated Paediatric Intensive Care Unit and Major Trauma Centre in the South West. The sickest babies and children in the region are therefore cared for right here in Bristol. Thanks to funding from The Grand Appeal, Bristol Children's Hospital is also home to a world-leading Neurosciences Centre, which includes the UK's first paediatric neurosurgical robot, state-of-the-art intraoperative MRI scanner, and BrainLab image guidance suite - only the third paediatric facility of its kind in Europe. Specifically the neuro department serves a huge paediatric population from across the South West and South Wales as well as farther afield servicing a paediatric population of up to 3 million children and young people.

BACKGROUND CONTINUED

St Michael's Hospital Neonatal Intensive Care Unit

The Neonatal Intensive Care Unit (NICU) is the only unit in the South West providing the highest level of care to critically ill and premature babies from across the region. The unit cares for over 800 babies a year, from those born as early as 23 weeks to babies requiring life-saving treatment when they are born full term.



The Cots for Tots Appeal and Cots for Tots House

The Cots for Tots Appeal, part of The Grand Appeal, works in partnership with the NICU as its dedicated charity by funding lifesaving equipment, pioneering research and technology, family support and additional facilities to help save tiny lives. Cots for Tots House is the only dedicated family accommodation facility for NICU parents from Bristol and across the South West and South Wales region with 11 en-suite bedrooms with associated facilities open to parents and families completely free of charge 24 hours a day, 365 days year.



Bristol Royal Hospital
For Children

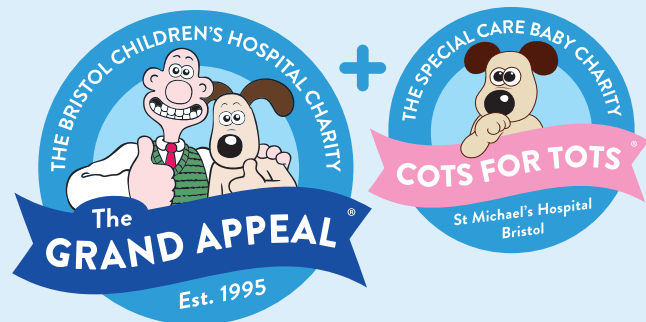

**Covering the
whole of the
SOUTH WEST
region and
SOUTH WALES**

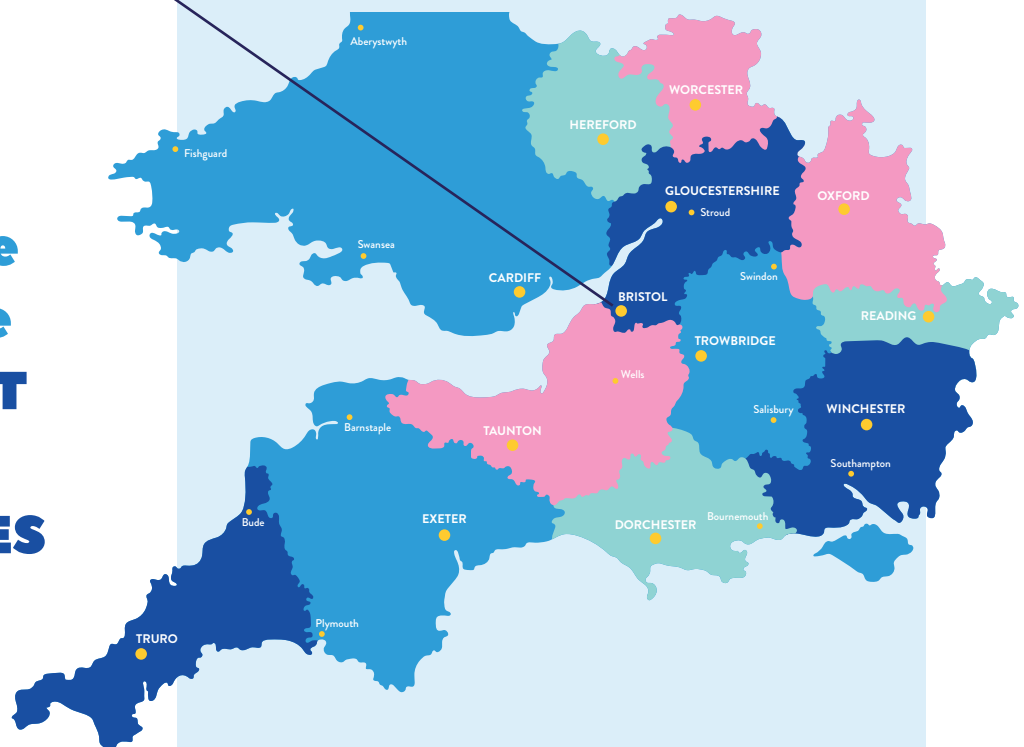

OVERVIEW: THE NEW PATIENT HOTEL PROPOSAL

In partnership with The Bristol Royal Hospital for Children, The Grand Appeal is creating a transformational new facility for patients and their families to support children and young people with highly complex medical needs such as those who may have experienced significant trauma following an accident or major surgery and children who require intensive therapy and support for life long conditions and need to spend many weeks or months receiving specialist treatment at Bristol Children's Hospital. Many families in this situation will find themselves far from home for very long periods of time while their child receives the specialist care that only Bristol Children's Hospital can provide.

The Grand Appeal is proposing to create a new development for Bristol Children's Hospital – the first of its kind for paediatric patients in the UK. This new Patient Hotel development will provide free accommodation for patients and their families under one roof, with therapy facilities onsite, allowing families to stay together whilst their child continues to receive the specialist care they need.

The new Patient Hotel will be transformational in the impact that it will have on children's healthcare in Bristol and across the South West and South Wales and will lead the way in the provision of healthcare for the UK. Given the huge geographic area covered by the children's hospital in Bristol, there are unique challenges for patients, families and for the specialist treatment they receive at the children's hospital. Those children from Wiltshire, Devon, Cornwall, Somerset, South Wales and sometimes further afield who need prolonged and daily therapeutic input to support their transition home from hospital or for a lifelong condition, are currently treated as in-patients in the children's hospital. This includes children who need rehabilitation after brain surgery or injury; children who have cystic fibrosis; children who need physiotherapy following major surgery; and children treated for chronic inflammatory conditions, such as rheumatoid arthritis. Currently, these children remain inpatients at BRHC for many months or during repeat visits, when they would benefit enormously from therapy in a less medicalised 'home-from-home' setting where they can be with their families and prepare to return home.



The Grand Appeal's new Patient Hotel proposal will provide purpose-built accommodation for patients and families in en-suite rooms, with shared facilities and garden for rest, play, cooking and relaxation. A new purpose-built therapy space, co-located with the patient and parent accommodation, will allow staff from the hospital to provide therapy to patients onsite in a more relaxed environment conducive to improved recovery for patients. The new Patient Hotel development will also create additional in-patient bed capacity in the children's hospital not only for the paediatric population of Bristol and local area, but also for patients from the whole South West region who require specialist treatment at Bristol Children's Hospital.

The new Patient Hotel proposal will build on the children's hospital's national and international reputation for excellence and innovation. In partnership with The Grand Appeal, this new development is a showcase for a ground-breaking new public and private sector partnership to deliver the very best outcomes for sick children and young people from Bristol and the whole South West and Wales region. This development is made possible through the incredible support of our longstanding partners at the Bristol-based Yogscast and the Jingle Jam Foundation whose fundraising efforts are surpassing £2m raised to date. The Grand Appeal is fortunate to benefit from huge community support and in return seeks to lead the way, again, by providing a transformational and ground-breaking new Patient Hotel development whilst improving the patient and family experience for children here in Bristol.

Additional information

For more information about the work of The Grand Appeal, please visit www.grandappeal.org.uk

For more information about Cots for Tots House, please visit www.cotsfortots.org.uk

For more information about The Bristol Royal Hospital for Children, please visit www.uhbristol.nhs.uk/patients-and-visitors/your-hospitals/bristol-royal-hospital-for-children/



CONSULTATION DRAWINGS

Site Location Plan

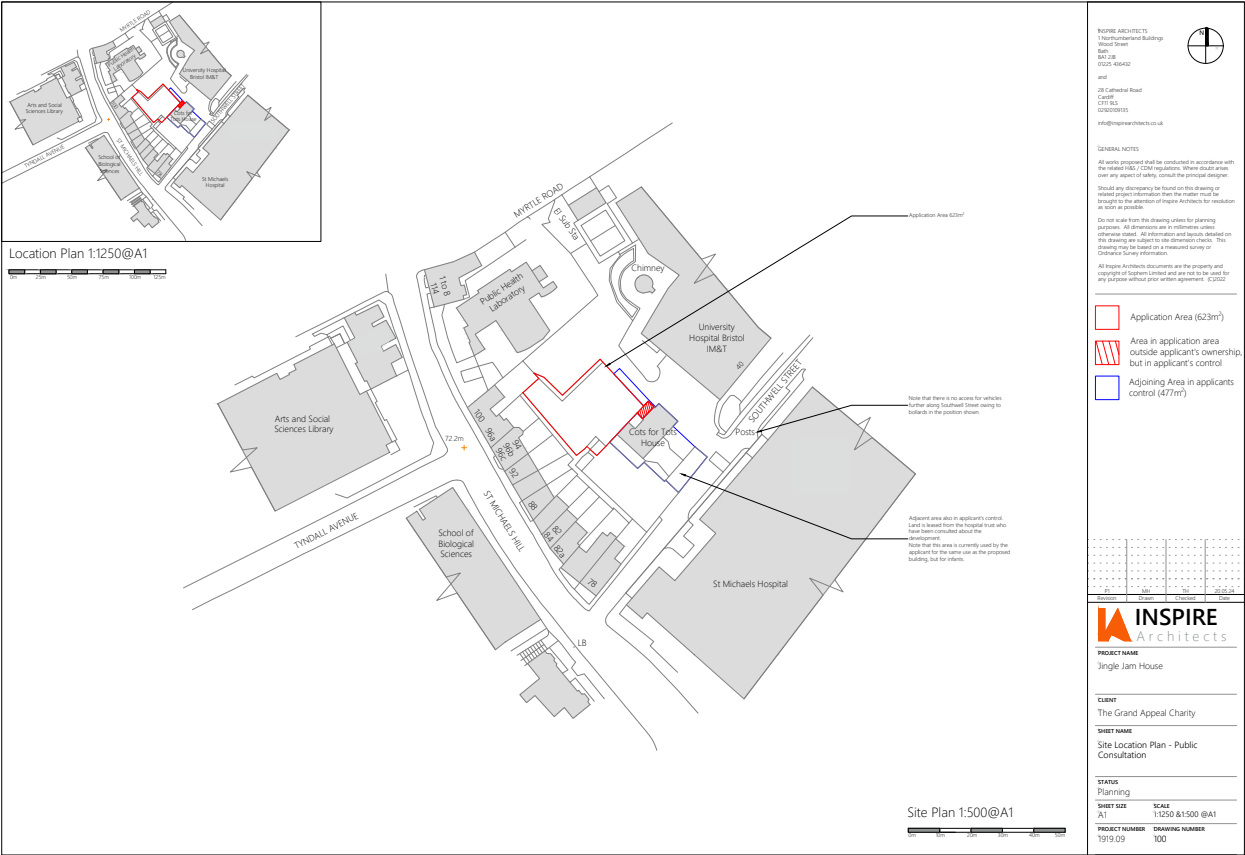

Proposed Site Plan



CONSULTATION DRAWINGS

Existing & Proposed West Elevations



Existing & Proposed East Elevations



CONSULTATION DRAWINGS

Existing & Proposed North Elevations



Existing & Proposed South Elevations



CONSULTATION FEEDBACK FORM

The design proposals for the new patient and family accommodation development on land adjacent to Cots for Tots House BS2 8EJ are available to view online at:

www.grandappeal.org.uk/latest-news/new-ground-breaking-facility-bristol-childrens-hospital

Alternatively, these proposals can be viewed in The Grand Appeal's HQ, at 30-32 Upper Maudlin St, Bristol BS2 8DJ by appointment. Please email hello@grandappeal.org.uk or telephone 0117 9273888 to arrange an appointment to visit in usual office hours.

If you wish to submit a comment on the proposals, please complete the template below or email The Grand Appeal at hello@grandappeal.org.uk.

Please note that personal details are not required, and feedback can be left anonymously. However, if you have a specific question and you wish to receive a specific response, we will need your contact details.

Name:

Email:

Postal address:

Please state your interest in the project: e.g. local resident, local business, interested party etc.

Please insert your comments below on the proposal.

The consultation is open from 24th May 2024 until 7th June 2024.

Please return your comments by **midnight on 7th June 2024**. You can return your feedback as follows:

1. By email to hello@grandappeal.org.uk
2. By post to The Grand Appeal, 30-32 Upper Maudlin St, Bristol BS2 8DJ
3. In person at the address above (open Monday to Friday 9am to 5pm)

All correspondence will be treated as confidential, and all feedback is considered as a valuable contribution towards assisting us with this project. Thank you.